

# ■ Installation

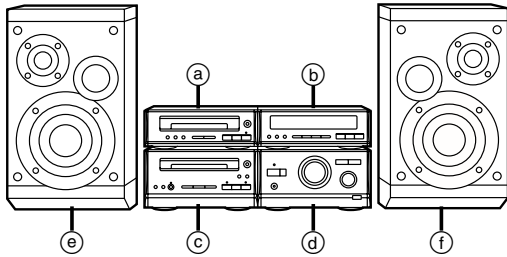

- (a) CD player (SL-HD501)
- (b) Tuner (ST-HD501)
- (c) Cassette deck (RS-HD501)
- (d) Amplifier (SE-HD501)
- (e) Left speaker (SB-HD501)
- (f) Right speaker (SB-HD501)

## Caution

Use the speakers only with the recommended system. Failure to do so may lead to damage to the amplifier and/or the speaker, and may result in the risk of fire. Consult a qualified service person if damage has occurred or if you experience a sudden change in performance.

## Note

- Do not put the CD player on the amplifier. The CDs can become hot and damaged.

# ■ Changing the Tone

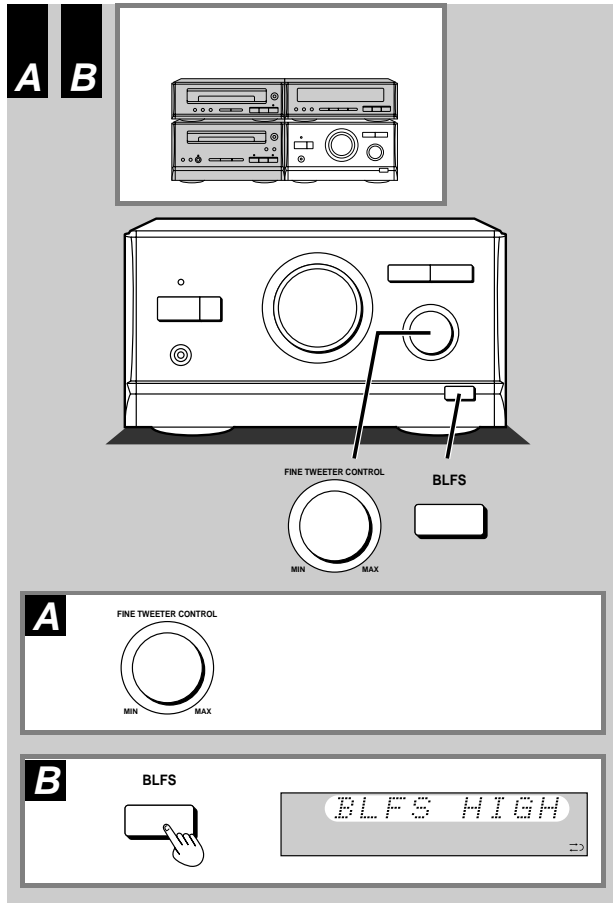

## Adjusting the treble range

This unit separates the tweeter and woofer so fine adjustments to the treble range can be made.

Turn **[FINE TWEETER CONTROL]** to adjust to the preferred sound quality.

Set it to MAX when you want to emphasize the treble range, or to MIN when you want to reduce it.

## Note

This effect is not discernible when using headphones.

## Emphasizing low frequency sounds

**BLFS (Brisk Low Frequency Sound)**

This effect increases the bass range to give music more power without interfering with the vocal range.

Press **[BLFS]**.

Each time you press the button;  
BLFS HIGH → BLFS LOW → BLFS OFF (FLAT)

**To cancel:**

Press **[BLFS]** to select "BLFS OFF". ("FLAT" will light.)